

ATTACHMENT TOOLS

ATTACHMENT TOOLS



WELCOME...



SPECIALISTS IN LANDSCAPE MAINTENANCE

GreenTec is a Danish company specialized in machines for the maintenance of green areas. Our products are based on almost 30 years of experience in the field.

We offer a large selection of hydraulic attachment tools for hedge trimming, verge mowing, windbreak maintenance, fence and guardrail trimming, ditch cleaning, etc. The tools are easily mounted on tractors, excavators and loaders through our Scorpion boom arms or Multi Carrier HXF series.

All machines are developed in a simple and functional design at our facilities in Denmark. We guarantee high quality and reliable products.

CONTENTS

HEDGEROW MAINTENANCE

Rotary Mulcher RM 232	4
Quadsaw LRS 1402	6
Quadsaw LRS 1602	7
Quadsaw LRS 2002	8
Quadsaw LRS 2402	9
Quadsaw LRS 4002 & 4802	10
Cutterbar HX 170 - 270	11

HEDGE CUTTING

Cutterbar HL 152 - 242	14
Rotary Hedge Cutter RC 102 - 162.....	15
NEW Cutterbar HS 172 - 242	16

VERGE MOWING

NEW Flail Mower FR 92 - 162	20
Barrier Mower RI 60 & 80	22
Rotary Crusher GT 135 & 155	23

VARIOUS TOOLS

Rotary Ditch Cleaner GR 70	24
Weed Clearing Brush BR 70 & 90	25
Multi Carrier HXF	26
Boom Mower Scorpion	28
Specifications	30



HEDGEROW MAINTENANCE

PERFECT CUTTING QUALITY

ROTARY MULCHER RM 232





7'7"

< 1.57"

2.5 mph

683 lb

2 years WARRANTY



STRONG ARGUMENTS

- Perfect cutting quality
- High capacity
- No disposal of cut-off material
- Minimal wear and maintenance
- Many mounting options

The Rotary Mulcher RM 232 provides enormous capacity and perfect performance. In one operation, branches are cut and instantly mulched.

Rotary Mulcher RM 232 has 4 rotors with 6 blades on each rotor. The free-hanging blades in the bottom cut the branches while the blades in the top pulverize them. In the case of an overload, the blades will rotate backward. Branches up to 1.57" are cut and crushed. The small twigs slowly sprinkle from the bottom of the machine to the ground and the decomposing process begins. RM 232 has a working width of 7'7" and is specially designed for windbreak and roadside maintenance in cutting intervals of up to three years. The working speed is up to 2.5 mph depending of the density of the hedge. Very large capacity and no clean up required.

ROTARY MULCHER RM	232
Working width	7'7"
Weight (lb)	683
Max. branch thickness	Ø1.57"
Oil flow (gpm)	13.2

QUADSAW LRS 1402



4'7"

< 3.94"

3.11 mph

106 lb

2 years WARRANTY



STRONG ARGUMENTS

- Perfect cutting quality
- Power Drive Transmission
- Saw blades with Widia teeth
- Low weight
- Flexible mounting brackets

The Quadsaw LRS 1402 is a small yet powerful quadsaw with four saw blades and a working width of 4'7".

The quadsaw is useful in multiple sectors, such as farming, municipal and private. The Quadsaw LRS 1402 is known for its perfect and clean cut of both thin and thick branches (up to 3.94"). It can adventurously be fitted on compact reach arms or the Multi Carrier HXF 2302 and HXF 2802.

QUADSAW LRS	1402
Working width	4'7"
Weight (lb)	106
Max. branch thickness	Ø3.94"
Oil flow (gpm)	6.6



- 5'3"
- < 4.72"
- mph
3.11
- lb
243

2
years
WARRANTY



STRONG ARGUMENTS

- Perfect cutting quality
- High forward speed
- Low power requirements
- Power Drive Transmission
- Saw blades with Widia teeth

The QuadSaw LRS 1602 differs from the larger models with its very low noise level, which make it suitable for use in both the agricultural and municipal segments. Each of the blades has a branch driver mounted. It ensures that branches are directed into the blades. Thick or thin branches are both cut smoothly.

The QuadSaw LRS 1602 is produced in high-strength steel and only weighs 243 lb.

QUADSAW LRS	1602
Working width	5'3"
Weight (lb)	243
Max. branch thickness	Ø4.72"
Oil flow (gpm)	10.6

QUADSAW LRS 2002



- 6'7"
- < 6.30"
- mph
3.11
- lb
437



STRONG ARGUMENTS

- Extreme performance
- High efficiency
- Saw blades with Widia teeth
- Power Drive Transmission
- Perfect cutting quality

Quadsaw LRS 2002 has an unmatched capacity with its four saw blades and low maintenance costs. The quadsaw is produced in high-strength steel with a low weight of 437 lb. All branches receive a smooth and clean cut.

QUADSAW LRS	2002
Working width	6'7"
Weight (lb)	437
Max. branch thickness	Ø6.30"
Oil flow (gpm)	13.2



7'10"

< 8.27"

3.11 mph

527 lb

2 years WARRANTY

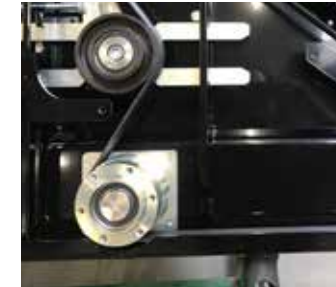

STRONG ARGUMENTS

- Perfect cutting quality
- Low power requirements
- Long life
- Power Drive Transmission
- Saw blades with Widia teeth

The Quadsaw LRS 2402 is the second largest saw in the series and has an enormous power and capacity. Branches up to 8.27" are cleanly cut - experienced drivers can manage branches up to 15".

The Quadsaw LRS 2402 can be fitted to reach arms, excavators, loaders and the Multi Carrier HXF 3302 - as long as they have the lifting capacity and at least 13.2 gpm oil available.

QUADSAW LRS	2402
Working width	7'10"
Weight (lb)	527
Max. branch thickness	Ø8.27"
Oil flow (gpm)	13.2

QUADSAW LRS 4002 & 4802



↑
↓
13'1" - 15'9"

< 8.27"

mph
3.11

lb
1124 - 1323

2
years
WARRANTY



STRONG ARGUMENTS

- Extreme performance
- High efficiency
- Saw blades with Widia teeth
- Power Drive Transmission
- Perfect cutting quality

GreenTec presents the world's largest saw with working widths of 13'1" and 15'9" for municipal and farming use. The saw is fitted to larger diggers, excavators and loaders. It goes without saying that the capacity is enormous.

QUADSAW LRS	4002	4802
Working width	13'1"	15'9"
Weight (lb)	1,124	1,323
Max. branch thickness	6.30"	8.27"
Oil flow (gpm)	2x13.2	2x13.2



- 5'7" - 8'10"
- < 4.33"
- 1.24 mph
- 397 - 573 lb



STRONG ARGUMENTS

- **Hardox steel trimmer bars**
- **Extreme lifespan**
- **Cutting frequency: 60 double strokes/min**
- **Soft Turn technology**
- **Hydraulic oil flow divider**

2
years
WARRANTY

A very strong and effective cutterbar used for cutting back trees and bushes. It has a clean cut and does not leave split or frayed branches. The cutterbar can be attached to reach mowers, excavators, and Multi Carrier HXF 3302.

CUTTERBAR HX	170	230	270
Working width	5'7"	7'7"	8'10"
Weight (lb)	397	485	573
Max. branch thickness	4.33"	4.33"	4.33"
Oil flow (gpm)	13.2	13.2	13.2





HEDGE TRIMMING
HIGH PERFORMANCE AND EFFICIENCY

CUTTERBAR HL 152 - 242



4'11" - 7'10"

< 1.57"

1.24 mph

132 - 159 lb

2 years WARRANTY



STRONG ARGUMENTS

- Fast Frequency Cut System, 200-400 cuts/min.
- Fingers with ball ends
- Fast replaceable blade
- Perfect cutting quality

The four models in the HL series are powerful hedge trimmers for the regular maintenance of hedges, both in the municipal, residential and agricultural sectors. The special fluted blades leave a smooth cut on the branches.

Branches up to 1.57" in thickness and small twigs are perfectly cut.

CUTTERBAR HL	152	182	212	242
Working width	4'11"	5'11"	6'11"	7'10"
Weight (lb)	132	141	150	159
Max. branch thickness	1.57"	1.57"	1.57"	1.57"
Oil flow (gpm)	10.6	13.2	13.2	13.2

ROTARY HEDGE CUTTER RC 102 - 162



3'3" - 5'3"

< 1.57"

1.55 mph

220 - 441 lb

2 years WARRANTY

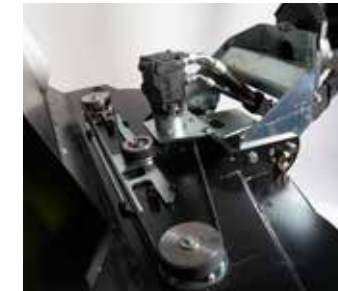
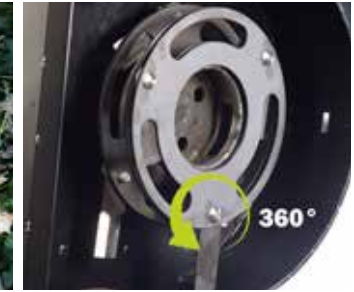

STRONG ARGUMENTS

- Reduction of diseases in the hedge
- No disposal of cut-off material
- Minimal wear and maintenance
- Enclosed cutter housing
- Low noise level

The Rotary Hedge Cutter RC is a professional attachment tool designed specifically for hedge cutting and developed for the discerning customer with a focus on: Cutting Performance, Efficiency, Output and Working Environment.

Rotary Hedge Cutter RC 102, 132 and 162 perform three workflows in one operation. The RC series cuts the hedge with a clean cut, the cut-off material is shredded and disposed by decay on the ground.

ROTARY HEDGE CUTTER RC	102	132	162
Working width	3'3"	4'3"	5'3"
Weight (lb)	220	331	441
Max. branch thickness	0.79"	1.18"	1.57"
Oil flow (gpm)	6.6	10.6	13.2

CUTTERBAR HS 172 - 242



NEW



CUTTERBAR HS 172 - 242



5'7" - 7'10"

< 2.36"

3.11 mph

265 - 320 lb

2 years WARRANTY



STRONG ARGUMENTS

- Perfect cutting quality
- Gentle and smooth cutter bar
- Double-sharpened blades
- Quick replacement of blades
- HD planetary gearbox w/cast iron engine

The new HS series is a very versatile machine as it can be used for both hedge trimming and windbreak maintenance.

The Cutterbar HS 172 - 242 can cut branches up to 2.36" in thickness. Even small twigs receive a completely smooth cut. By combining the newly developed finger bars with the specially sharpened blades, you achieve a high performance and an impeccable finish.

CUTTERBAR HS	172	212	242
Working width	5'7"	6'11"	7'10"
Weight (lb)	265	291	320
Max. branch thickness	2.36"	2.36"	2.36"
Oil flow (gpm)	10.6	13.2	13.2



GREENTEC R162



VERGE MOWING

EFFORTLESS MAINTENANCE

FLAIL MOWER FR 92 - 162



NEW

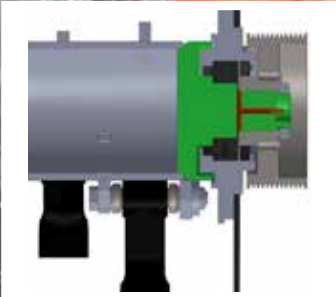

OPTIMIZED TOTAL WIDTH

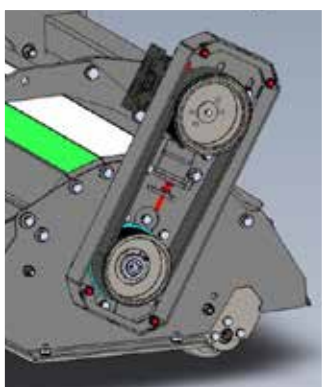

POWER BELT DRIVE

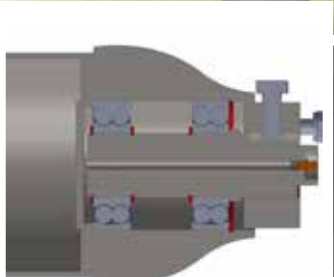

REAR ROLLER



OPTIMIZED SHAPE OF FLAILS

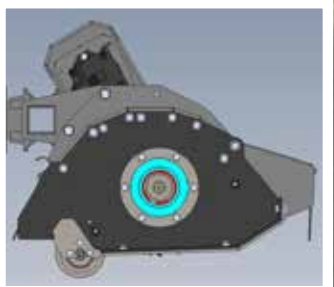

INTEGRATED AIRFLOW

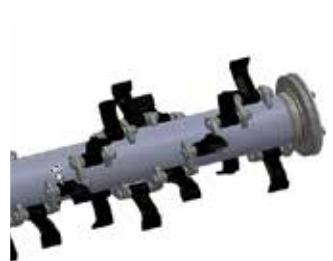

DOUBLE SPIRAL ROTOR





- 2'11" - 5'3"
- < 1.57"
- mph
3.11 - 4.35
- lb
304 - 794

2
years
WARRANTY



STRONG ARGUMENTS

- **Integrated Airflow increases the capacity**
- **Integrated rotor bearings**
- **Power Belt drive**
- **Strenx 700 steel construction**
- **Double spiral rotor with uniform flow**

The Integrated Airflow system is one of the main features of the new FR series. The space between the rotor and the shield is purposely designed to increase the air velocity so the cut-off material exits the mower as quickly as possible. It creates a natural vacuum that sucks the grass into the mower. This increases the capacity of the flail head and reduces the power requirement. The main bearings are integrated in the rotor shaft which reduces the total width of the flail head. The flails are adapted to the rotor to stop breakage and damage from happening. The machines are manufactured in Strenx 700 high strength steel which is one of the most durable steel types in the world.

FLAIL MOWER FR	92	112	122	162
Working width	2'11"	3'7"	3'11"	5'3"
Weight (lb)	304	317	705	794
Oil flow (gpm)	10.6	10.6	22.5	22.5
Alt. oil flow (gpm)	13.2	13.2	26.4	26.4

BARRIER MOWER RI 60 & 80



STRONG ARGUMENTS

- Anti-scalping protection disc
- Good ground following capability
- Adjustable spiral springs
- Rubber protection around the disc
- Two blades for uniform cutting results

2
years
WARRANTY

The Barrier Mower RI 60 & 80 is the ideal tool to cut under fence wires, horse pen fences, crash barriers or to cut close around trees in orchards. Below the spring-suspended free-hanging plate, there are two strong updraft blades that mow the grass.

BARRIER MOWER RI	60	80
Working width	2'	2'7"
Weight (lb)	99	132
Support plate	Std.	Std.
Min./alt. oil flow (gpm)	10.6/6.6	10.6/6.6

ROTARY CRUSHER GT 135 & 155



- 4'5" - 5'1"
- < 2.76"
- mph
3.11
- lb
904 - 1014

2
years
WARRANTY



STRONG ARGUMENTS

- Perfect for shrubbery
- Double deck
- Low maintenance costs
- Pendant suspension
- 2 cutting systems

The Rotary Crusher GT 135 & 155 is specially developed for use in extreme conditions with many stones and stumps. It comes with two cutting systems: chains or blades. The chains are used for mowing grass and shrubs in stony conditions. The blades are used for hedge cutting and grass mowing in normal conditions. Both systems are very robust.

ROTARY CRUSHER GT	135	155
Working width	4'5"	5'1"
Weight (lb)	904	1014
Max. branch thickness	2.76"	2.76"
Min./alt. oil flow (gpm)	22.5/29.1	22.5/29.1

ROTARY DITCH CLEANER GR 70



↔
2'2"

⊙
mph
0.62

⊙
lb
485

2
years
WARRANTY



STRONG ARGUMENTS

- Efficient cleaning of ditches
- Continuous duty motor
- Skid shoe
- Adjustable front hood
- Hydraulic driven

The Rotary Ditch Cleaner GR 70 is a highly efficient machine for cleaning of smaller ditches and streams. The sludge and weeds are effectively removed and thrown up on the cliff.

The ditch cleaner is hydraulic driven and can be fitted to a boom arm.

ROTARY DITCH CLEANER GR	70
Working width	2'2"
Weight (lb)	485
Min. oil flow (gpm)	15.9
Alt. oil flow (gpm)	18.5

WEED CLEARING BRUSH BR 70 & 90



↔
2'4" - 2'11"

⊙
mph
0.62

⊙
lb
121-507

2
years
WARRANTY



STRONG ARGUMENTS

- Powerful and effective
- Hard steel brushes
- Hydraulic driven
- Durable

The Weed Clearing Brush BR 70 & 90 effectively cleans sidewalks, gutters, bicycle paths, courtyards, anywhere where there are tiles, asphalt or paving stones. The strong steel brushes easily remove dirt, sludge and weeds.

WEED CLEARING BRUSH BR	70	90
Working width	2'4"	2'11"
Weight (lb)	121	507
Directional and pressure relief valves	-	Standard
Oil flow (gpm)	6.6	13.2

MULTI CARRIER HXF



MOUNTING OPTIONS - HXF OR SCORPION...

All our tools are hydraulic powered which means that the hydraulic oil must be supplied to make the bars, flails and blades run. GreenTec offers two mounting options for our tools: The Multi Carrier HXF series or the Boom Mower Scorpion series. Both solutions are described in detail on the following pages. Alternatively, the tools can be mounted on various excavators and other manufacturers of reach arms. We also offer a large selection of adapters and brackets for mounting. Further information at www.greentec.eu

HXF 2302 & 2302 TELE



6
Tools

6.6
gpm

AHS 45°

2
years
WARRANTY

The GreenTec Multi Carrier HXF 2302 is the lightest model in the series. It can easily be mounted on smaller vehicles, such as skid steer loaders and compact tractors with a minimum weight of 2,646 lb.

A wide variety of tools can be attached to the Multi Carrier HXF 2302 for hedge trimming and windbreak maintenance as well as fence mowing and cleaning of sidewalks. A hydraulic and mechanical quick release system makes it easy to swap between tools.

The hydraulic system of the vehicle must be able to deliver oil of 6.6 gpm. The cutting head can be adjusted from a vertical to horizontal position through a spindle.

HXF 2802 & 2802 TELE



12
Tools

6.6 - 10.6
gpm

AHS 45°

2
years
WARRANTY

The Multi Carrier HXF 2802 can be installed on front end loaders and large skid steer loaders in a few minutes.

A large selection of tools for hedge cutting and hedgerow trimming is available. It is also possible to mount a barrier mower or weed brush on the Multi Carrier HXF 2802.

The arm has a hydraulic break-back system with Auto Reset which also acts as a cushion to the saw.

HXF 3302 & 3302 TELE



14
Tools

10.6 - 13.2
gpm

AHS 45°

2
years
WARRANTY

The Multi Carrier HXF 3302 is the largest model in the HXF series and is mainly mounted on telehandlers, large front end loaders and backhoes.

A large selection of tools for hedge trimming and shelter-belt maintenance can be fitted to the Multi Carrier HXF frame, such as the quadsaws and cutterbars.

The HXF 3302 is mounted in the loading bracket of the vehicle. The mounting process only requires a few minutes of your time.

The arm has an automatic hydraulic break-back system with pre-pressure which optimizes the workflow and prevents overload from happening.

MODEL	2302	2302 T*
Reach (center vehicle/end Quadsaw)	5'11"	3'11" - 5'11"
Reach (center vehicle/end RI 80)	7'10"	7'10"
Transport width	4'3"	5'11"
Min. oil flow (gpm)	6.6	6.6
Alt. oil flow (gpm)	-	-
Weight without bracket (lb)	243	282

	2802	2802 T*
Reach (center vehicle/end Quadsaw)	7'3"	4'7" - 7'3"
Reach (center vehicle/end RI 80)	-	-
Transport width	6'7"	7'10"
Min. oil flow (gpm)	6.6	6.6
Alt. oil flow (gpm)	10.6	10.6
Weight without bracket (lb)	331	386

	3302	3302 T*
Reach (center vehicle/end Quadsaw)	8'2"	4'11" - 8'2"
Reach (center vehicle/end RI 80)	-	-
Transport width	7'3"	8'2"
Min. oil flow (gpm)	10.6	10.6
Alt. oil flow (gpm)	13.2	13.2
Weight without bracket (lb)	441	507

* THE HXF TELE MODELS ARE AVAILABLE IN 2021.

BOOM MOWER SCORPION



 **MADE IN DENMARK**

AVAILABLE IN MID 2022



SCORPION 4 S



The Scorpion 4 S is available in two models which can either be front or rear mounted.

The series is dedicated to smaller tractors with a weight of 3,307 lb and above. It can also be fitted on skid steer loaders and implement carriers.

As a standard, the Danfoss hydraulic valve is controlled by the proportional mini joystick and Hybrid Arm System. A wide range of attachment tools makes the Scorpion a popular choice throughout the entire year.

MODEL	330-4 S	430-4 S
Horizontal reach	10'10"	14'1"
Vertical reach	15'9"	18'1"
Transport width	5'11"	7'3"
Hydraulic system	13.7 gpm @ 3046 psi	
Min. size of vehicle (lb)	3,307	4,409
Weight (lb)	1,058	1,146

SCORPION 6 S & 6 PLUS



The Scorpion 6 series is available in four models and you can choose between front or rear mount.

The Scorpion 6 series is designed for medium-sized tractors with a weight of at least 8,819 lb. The patent pending 4-point mounting system connects the tractor and the boom mower and gives 100% stability. It is also easy to mount.

The Hybrid Arm System provides great flexibility and increases the work capacity and environment. The Danfoss hydraulic system on the 6 PLUS models ensures high reliability and output. Furthermore, the joystick is easy to operate.

	530-6 S	630-6 S	530-6 PLUS	630-6 PLUS
Horizontal reach	17'5"	20'8"	17'5"	20'8"
Vertical reach	24'7"	27'11"	24'7"	27'11"
Transport width	7'3"	7'3"	7'3"	7'3"
Hydraulic system	30.4 gpm @ 3336 psi		33 gpm @ 4569 psi	
Min. size of vehicle (lb)	8,819	11,023	8,819	11,023
Weight (lb)	2,723	2,800	3,020	3,075

SCORPION 8 S & 8 PLUS



The Scorpion 8 series represents the largest boom mowers in the Scorpion range. It consists of four models.

The Scorpion 8 series is suitable for large tractors with a weight of 13,228 lb and above.

All scorpion models are manufactured in Strenx 700 high strength steel. You truly see the greatness of the Strenx steel at the longer reaches as it reduces the weight while increasing the strength.

The boom mowers are easily fitted with a 4-point mounting system which is connected to the 3-point hitch of the tractor and two K80 ball hitches as well.

	730-8 S	830-8 S	730-8 PLUS	830-8 PLUS
Horizontal reach	23'11"	27'3"	23'11"	27'3"
Vertical reach	31'2"	34'5"	31'2"	34'5"
Transport width	7'10"	8'2"	7'10"	8'2"
Hydraulic system	30.4 gpm @ 3336 psi		33 gpm @ 4569 psi	
Min. size of vehicle (lb)	13,228	15,432	13,228	15,432
Weight (lb)	3,252	3,318	3,527	3,594

TECHNICAL SPECIFICATIONS



	ROTARY MULCHER	QUADSAW						CUTTERBAR		
ATTACHMENT TOOLS:	RM 232	LRS 1402	LRS 1602	LRS 2002	LRS 2402	LRS 4002	LRS 4802	HX 170	HX 230	HX 270
Working width	7'7"	4'7"	5'3"	6'7"	7'10"	13'1"	15'9"	5'7"	7'7"	8'10"
Weight (lb)	683	106	243	437	527	1124	1323	397	485	573
Max. branch thickness	Ø1.57"	Ø3.94"	Ø4.72"	Ø6.30"	Ø8.27"	Ø6.30"	Ø8.27"	Ø4.33"	Ø4.33"	Ø4.33"
Max. working speed (mph)	2.5	3.11	3.11	3.11	3.11	3.11	3.11	1.24	1.24	1.24
Min. oil flow (gpm/psi)	13.2/2611	6.6/2756	10.6/2756	13.2/2611	13.2/2611	2x13.2/2611	2x13.2/2611	13.2/2756	13.2/2756	13.2/2756
Alt. oil flow (gpm/psi)	-	-	-	22.5/2176	22.5/2176	1x26.4/2611	1x26.4/2611	-	-	-
MOUNTING OPTIONS:										
HXF	-	2302/2802	2802/3302	3302		-	-	3302		-
SCORPION	6/8	4	4/6/8	6/8		-	-	6/8		-

	ROTARY CRUSHER		BARRIER MOWER		DITCH CLEANER	WEED CLEARING BRUSH	
ATTACHMENT TOOLS:	GT 135	GT 155	RI 60	RI 80	GR 70	BR 70	BR 90
Working width	4'5"	5'1"	2'	2'7"	2'2"	2'4"	2'11"
Weight (lb)	904	1014	99	132	485	121	507
Max. branch thickness	Ø2.76"	Ø2.76"	-	-	-	-	-
Max. working speed (mph)	3.11	3.11	1.86	1.86	0.62	0.62	0.62
Min. oil flow (gpm/psi)	22.5/4061	22.5/4061	10.6/2756	10.6/2756	18.5/4641	6.6/2756	13.2/2756
Alt. oil flow (gpm/psi)	29.1/4351	29.1/4351	6.6/2756	6.6/2756	-	10.6/2756	-
MOUNTING OPTIONS:							
HXF	-	-	2302/2802		-	2302/2802	-
SCORPION	6/8		4		6/8	4	6/8

CUTTERBAR				ROTARY HEDGE CUTTER			CUTTERBAR			FLAIL MOWER			
HL 152	HL 182	HL 212	HL 242	RC 102	RC 132	RC 162	HS 172	HS 212	HS 242	FR 92	FR 112	FR 122	FR 162
4'11"	5'11"	6'11"	7'10"	3'3"	4'3"	5'3"	5'7"	6'11"	7'10"	2'11"	3'7"	3'11"	5'3"
132	141	150	159	220	331	441	265	291	320	304	317	705	794
Ø1.57"	Ø1.57"	Ø1.57"	Ø1.57"	Ø0.79"	Ø1.18"	Ø1.57"	Ø2.36"	Ø2.36"	Ø2.36"	Ø1.57"	Ø1.57"	Ø1.57"	Ø1.57"
1.24	1.24	1.24	1.24	1.55	1.55	1.55	3.11	3.11	3.11	3.11-4.35	3.11-4.35	3.11-4.35	3.11-4.35
5.3/2756	6.6/2756	6.6/2756	6.6/2756	6.6/2756	10.6/2756	13.2/2611	10.6/2756	13.2/2756	13.2/2756	10.6/3336	10.6/3336	22.5/3336 22.5/315	22.5/3336 22.5/315
8.5/2756	10.6/2756	10.6/2756	10.6/2756	-	-	-	-	-	-	13.2/3336	13.2/3336	26.4/3336 26.4/4569	26.4/3336 26.4/4569
2302/2802	2802/3302	-	2302/2802	2802/3302	3302	2802/3302	3302	2802/3302	3302	2802T/3302T	3302 T	-	-
4	4/6/8		4	6/8	4	6/8	4	6/8	4	4/6/8	6/8		



GreenTec offers the widest selection of tools for landscape maintenance. See more www.GreenTec.eu

2
years
WARRANTY

OUR WARRANTY

GreenTec provides a 2-year warranty on all machines. See more on our website: www.greentec.eu

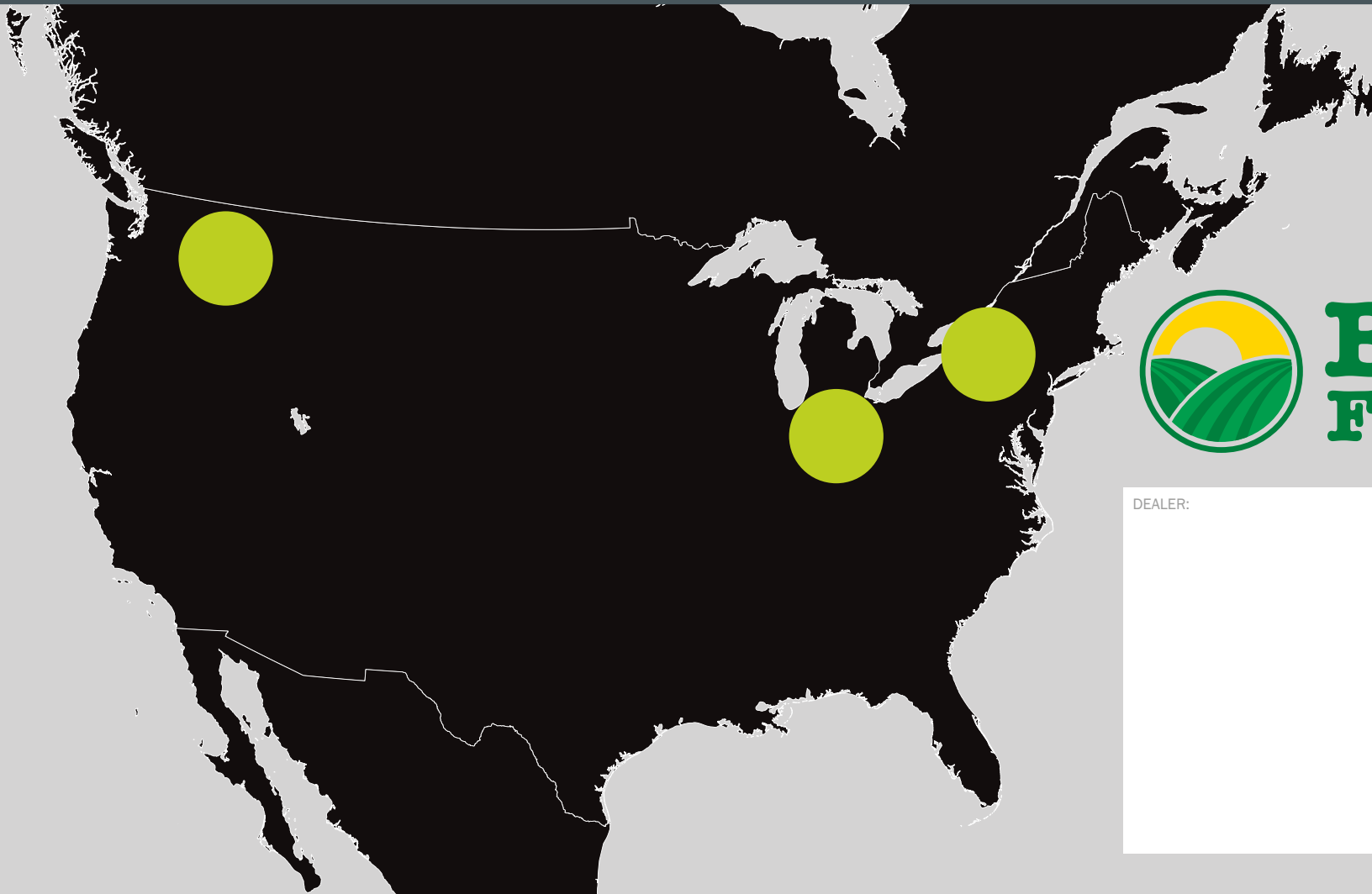

Buckeye Farmers

DEALER:

We reserve the right to make technical changes. Technical information and images are approximated. VER 3.0 EN

GREENTEC
Cutting Edge Technology

Buckeye Farmers LLC | Eaton | OH 45320 | USA
Tel.: 937-733-1729 | trhodus@buckeyefarmers.com
www.buckeyefarmers.com/greentec

